

Love Notes | (3) 2- page layouts



Materials Needed:

CC12417 Love Notes Scrapbooking Bundle -

- CC12410 Love Notes Paper Packet + Sticker Sheet
- CC12412 Love Notes Coordinating Cardstock
- White Daisy Cardstock (3)
- Photo Placeholders
- CC12415 Love Notes Puffy Stickers
- CC12414 Love Notes Stamp + TC

Additional supplies:

Intense Black Ink Stamp Pad or Black Exclusive Inks™ Stamp Pad or Archival Black

Peach Exclusive Inks™ Stamp Pad

Candy Apple Exclusive Inks™ Stamp Pad

My Acrylix® Block (suggested sizes: 2x2, 2X3.5 and 3X3)

Z5038 Die-cutting & Embossing Machine

Blending Brush

LePen Black

12" Trimmer

Scissors

Adhesive

3-D Foam Tape

Getting started:

- Gather all materials needed.
- All measurements are listed in the cutting guide, as well as below are the H X W.
- Start by placing a post-it note, or small piece of paper, with the project #'s on them, as this will be where you place all the pieces once they are cut.
- Cut all the papers according to the cutting guide and add them to the correct layout pile.

Cutting Guide Key:

- #= use reverse side of paper
- 1L,1R, 2L etc refers to left or right and project # (1,2,3 etc)
- STC= Stamp + Thin Cut
- TC= Thin Cut
- FC= Fussy Cut
- DT = dovetail

Base Pages:

Project 1- (2) Toffee

Project 2- (2) Scarlet

Project 3- (2) Peach

Gather Photos:

Project #1- (4) 4 X 6

Project #2- (2) 4 X 3, (2) 6 X 4

Project #3- (3) 3 X 4, (2) 4 X 4, (1) 6 X 4

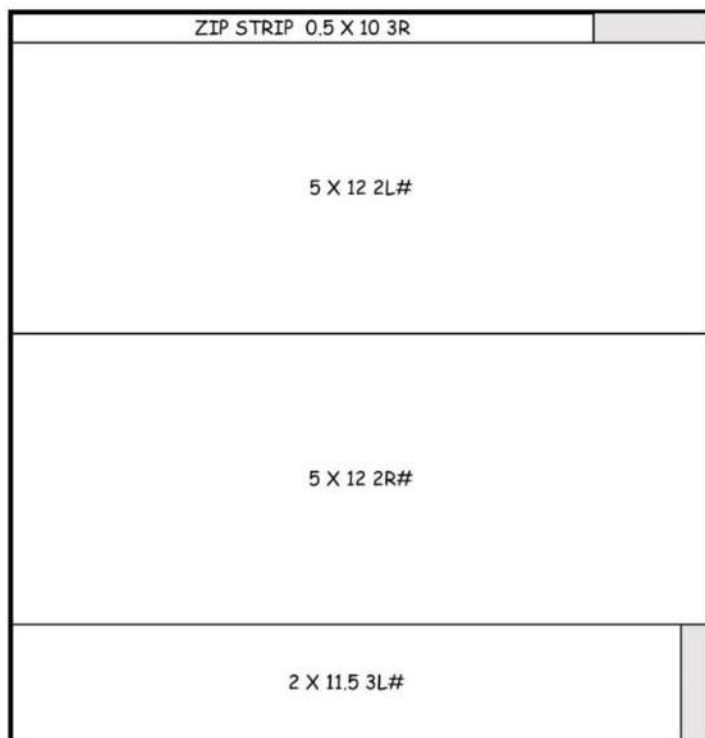
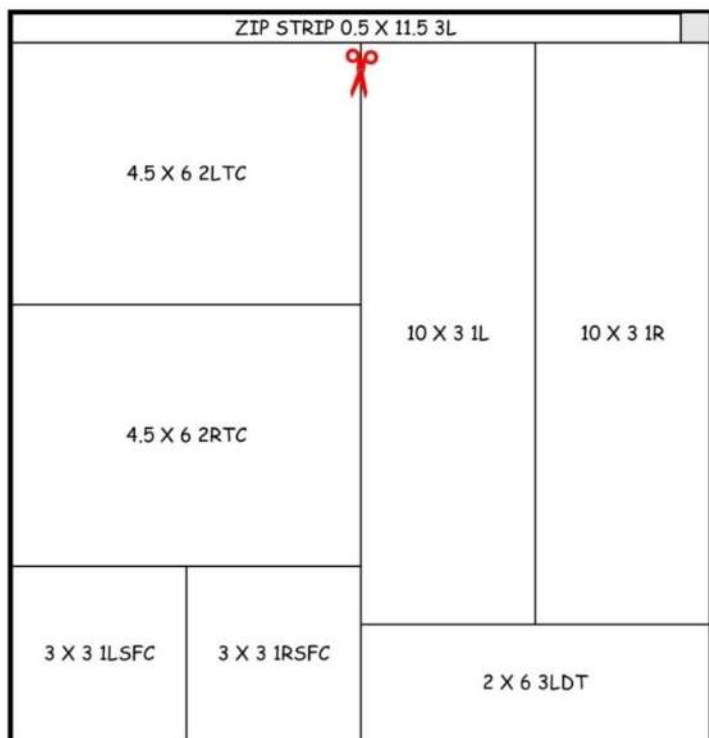
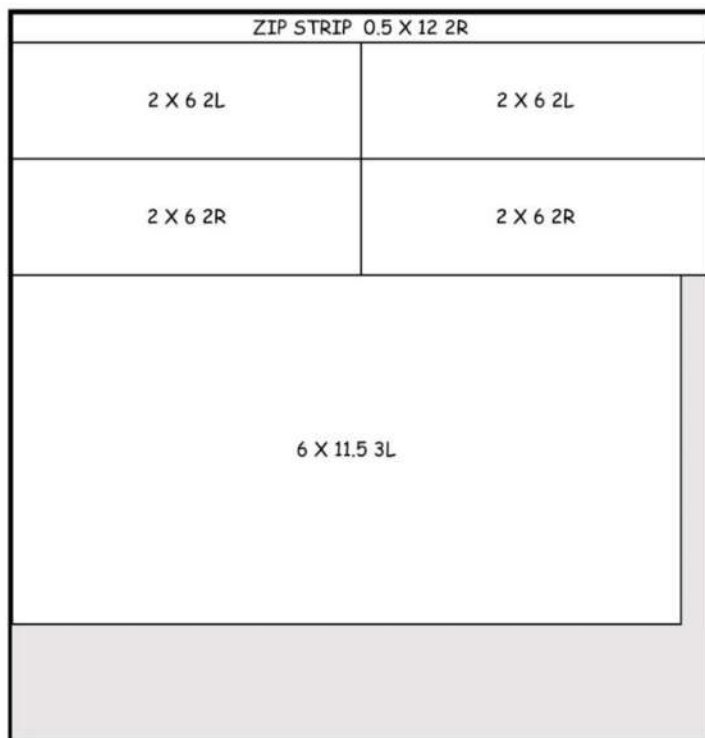
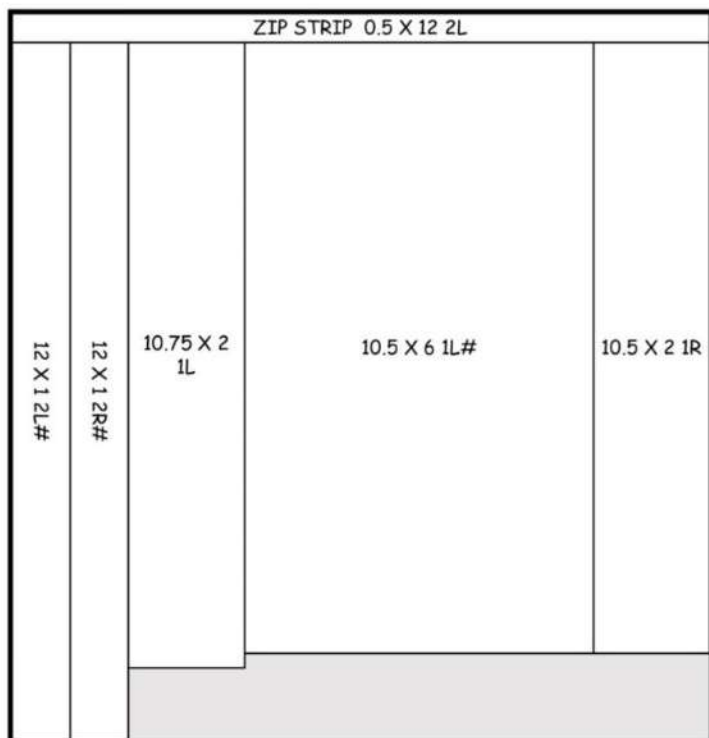

Cutting legend:

Measurements are H x W, # = Use Reverse side of paper shown above
 DT = Dovetail Trim , D= Diagonal cut, STC= Stamping, and Thin Cut, TC = Thin cut, FC= Fussy Cut
 Notations : 1L,1R, 2L etc refers to left or right and project # (1,2,3 etc)

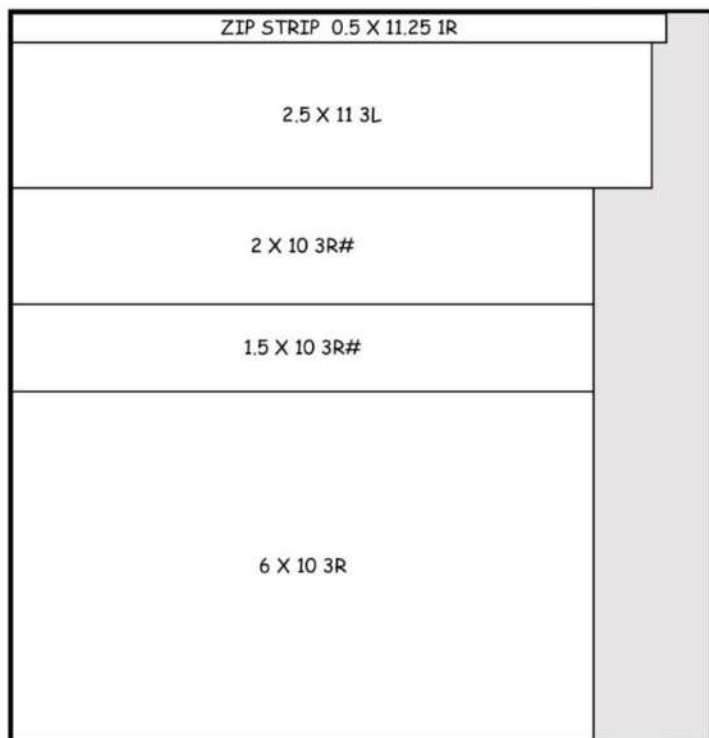
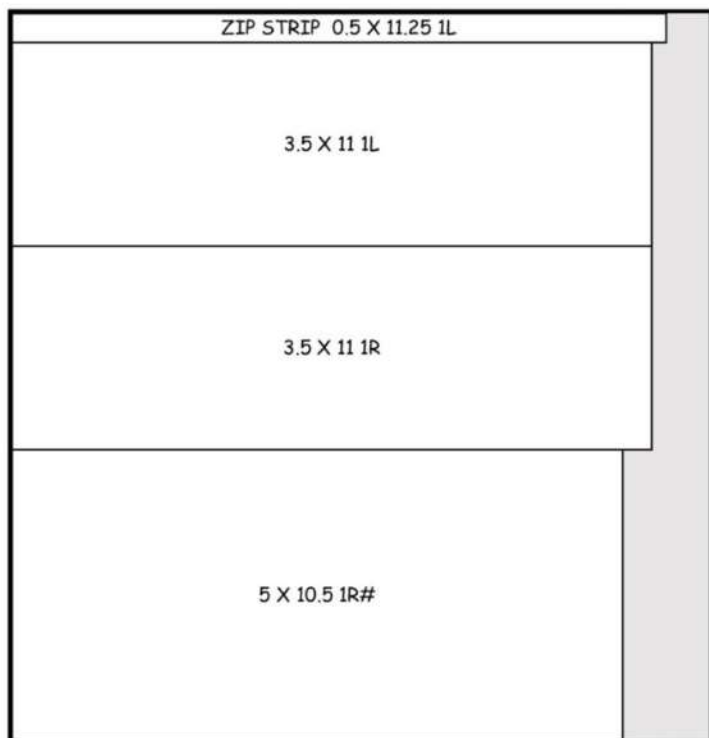

Shortbread

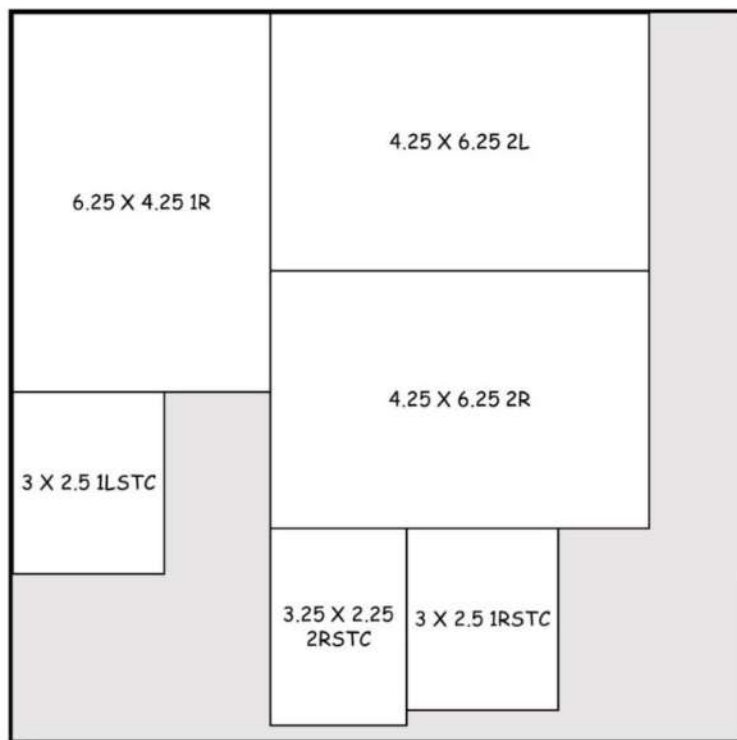
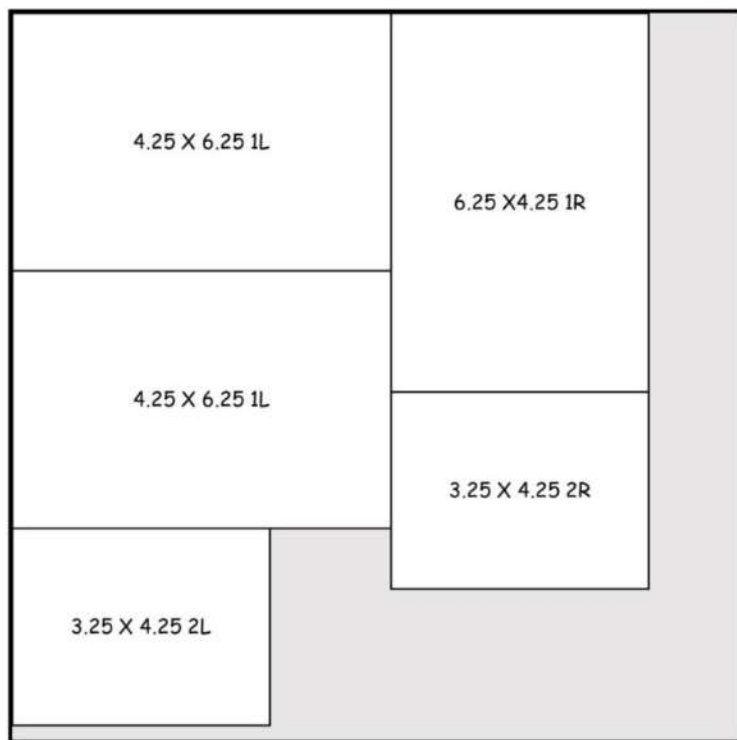

Cutting legend:

Measurements are H x W, # = Use Reverse side of paper shown above
 DT = Dovetail Trim, D= Diagonal cut, STC= Stamping, and Thin Cut, TC= Thin cut, FC= Fussy Cut
 Notations : 1L,1R, 2L etc refers to left or right and project # (1,2,3 etc)

Candy Apple

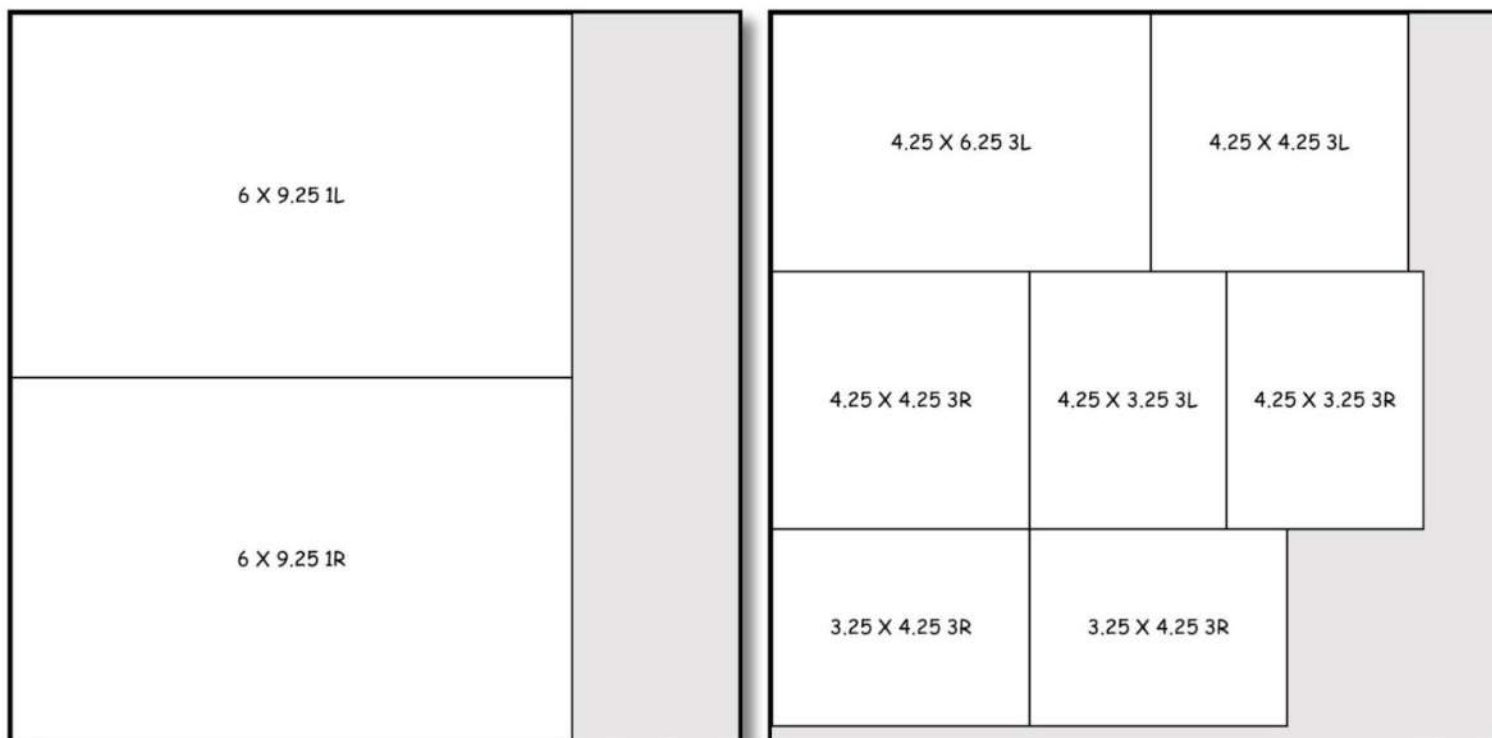

White Daisy

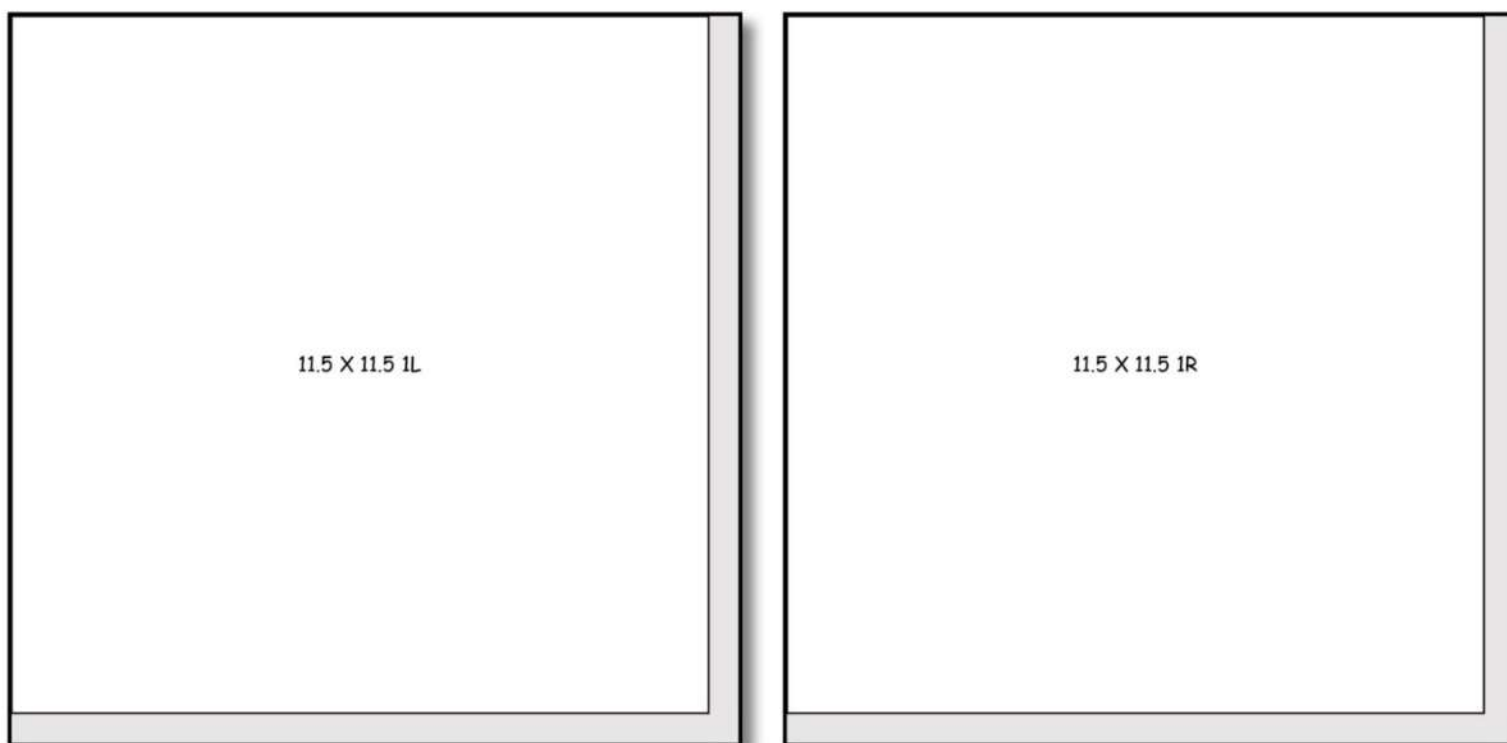

Cutting legend:

Measurements are H x W, # = Use Reverse side of paper shown above
 DT = Dovetail Trim, D= Diagonal cut, STC= Stamping, and Thin Cut, TC= Thin cut, FC= Fussy Cut
 Notations : 1L,1R, 2L etc refers to left or right and project # (1,2,3 etc)

White Daisy

11.5 X 11.5 3L

11.5 X 11.5 3R

0.5 X 12 2L

0.5 X 12 2R

3 X 4 3R

Cutting legend:

Measurements are H x W, # = Use Reverse side of paper shown above
 DT = Dovetail Trim , D= Diagonal cut, STC= Stamping, and Thin Cut, TC= Thin cut, FC= Fussy Cut
 Notations : 1L,1R, 2L etc refers to left or right and project # (1,2,3 etc)

Project 1- Double Page Layout



Prepare (both pages) - Toffee bases

- Stamp and Thin cut the Shortbread Teddy bears
- Fussy cut the ears, paws and tummies from the Dot paper and add to the Shortbread bears
- Adhere the White Daisy pieces to the Toffee bases
- On the left page add Peach ink with a blending brush in the upper left corner
- On the right page add Peach ink with a blending brush in the upper right and lower right

Assemble: both pages

- Adhere the Candy Apple flush with the inner edge and 1 5/8" from the bottom
- Adhere the Heart paper flush with the inner edge and 3 3/8" from the bottom
- Left-Adhere the Teddy paper 3/4" from the inner edge and bottom. Right-Adhere the Striped paper 3/4" from the inner edge and the bottom
- Adhere the Dot paper flush with the inner edge and 2" from the bottom
- Adhere the Floral print flush with the inner edge and 2.5" from the bottom
- Adhere the Zip Strip below the Small Heart Print
- Add stickers and embellishments
- Stamp hearts in Candy Apple and Peach above the Heart paper
- Add photos with mats

Project 2- Double Page Layout



Prepare (both pages)- Scarlet bases

- Assemble one closed envelope for the left page and one open envelope for the right page
- Stamp the White Daisy strips with text stamps alternating the colors from Peach to Candy Apple

Assemble: both pages

- Adhere the Floral print flush with the inner edge and 1/2" from the bottom
- Adhere the Zip Strip 2.5" from the bottom
- Adhere the stamped White Daisy pieces 3" from the bottom
- Adhere the Text paper 3.5" from the bottom
- Adhere the Teddy paper 8.5" from the bottom
- Adhere the Floral paper flush with the inner edge and 9.5" from the bottom
- Left page- seal the envelope, adhere
- Right page- assemble the envelope as in photo, tuck in the Shortbread journal piece and adhere
- Add stickers and embellishments
- Add photos with mats

Project 3- Double Page Layout



Prepare (both pages) Peach bases

- Adhere the White Daisy pieces to the Peach bases
- Stamp the journaling box for the right page by stamping the heart with Peach ink and the "Be mine" and "Valentine" with Candy Apple ink, add journaling lines with Black LePen is desired
- Dovetail the Peach piece for title

Assemble: left page

- Adhere the Zip Strip 1/4" from the edge of the White Daisy
- Adhere the Floral paper 3/4" from the inner edge of the White Daisy
- Adhere the Text paper 6 3/4" from the inner edge of the White Daisy
- Adhere the Heart paper with a 1/4" border to the outer edge of the White Daisy
- Adhere the Peach Dot title piece 2" from the top

Assemble: right page

- Adhere the Striped paper 1" from the inner edge and 1" from the bottom
- Adhere the Heart paper 3" from the inner edge and 1" from the bottom
- Adhere the Zip Strip 9" from the inner edge and 1" from the bottom
- Adhere the Striped paper 9.5" from the inner edge and 1" from the bottom

Assemble: both pages

- Adhere stickers and embellishments
- Add photos with mats

